

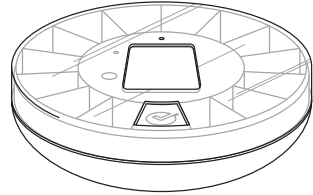

Welcome!

SETTING UP YOUR DOSE DISPENSE

- 1 Remove the Dose Dispense from the package. Decide where in your home you would like to dispense medications.



- 2 Plug your pillbox into a wall outlet with the supplied USB cord.

Keep it plugged in when not traveling to ensure the battery stays charged.

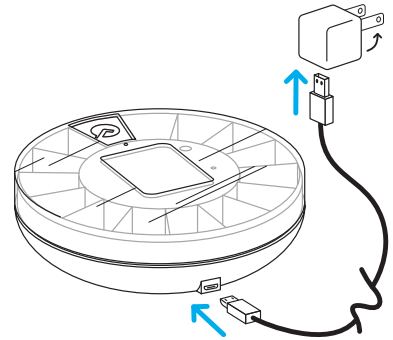

- 3 The on-screen guide will start automatically. Follow the steps and you will be dispensing pills in no time!

You'll need to use a slight amount of pressure when touching the screen.

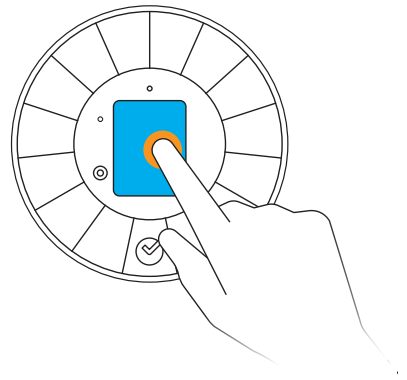

DISPENSING PILLS

To dispense pills, **FLIP THE PILLBOX** into a hand or cup. If the pillbox is not flipped, that dose will be marked as missed.

- When it's time to dispense, the tray will rotate to reveal the pills and a short sound will play. Simply **FLIP THE PILLBOX** to dispense the pills
- After 10 minutes, if not dispensed, a soft alarm will begin playing
- After 20 minutes, a loud alarm will play more frequently
- After 30 minutes, if connected to Dose Anywhere, text or email reminders will be sent to linked accounts
- If the pillbox is not flipped for 2 hours, the device will close and the dose will be marked as missed

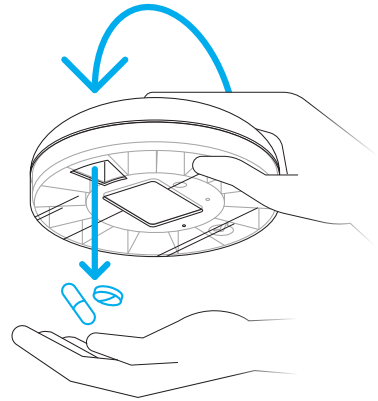

USING THE HOME MENU

The home menu will give you an overview of the state of the Dose Dispense.

1. The **STATUS BAR** will let you know the current time and the state of the alarm, WiFi connection and the battery
2. The **SCHEDULE** will always display the next time pills are scheduled to be taken and which compartment will open
3. Press the **ARROWS** on the bottom of the touch screen to shift between different menus

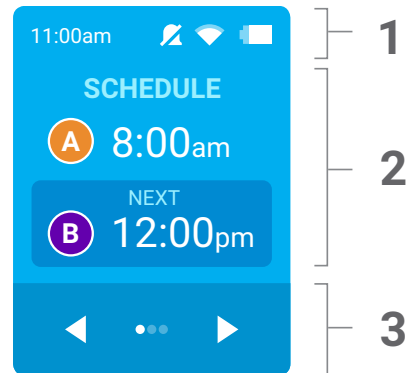

ACCESSING SETTINGS MENUS

To access the device settings, **UNSCREW THE LID**, The main settings screen will be displayed.

Use the **ARROWS** at the bottom of the touch screen to navigate left and right through the screens shown below.

Many menu screens have a white **ACTION BUTTON** that you can press to activate the feature.

To return to the home menu, simply **REPLACE THE LID**, this can be done from any settings menu screen.

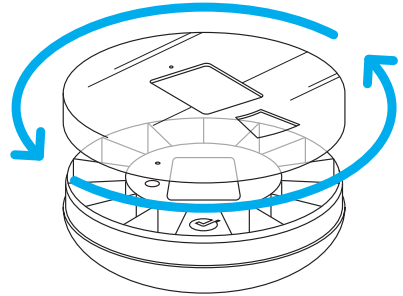

Unscrew the lid to access settings, replace the lid to return to the home menu

PRESS the left and right **ARROWS** to cycle through the various menus

PRESS the white **ACTION BUTTON** on the menu when you want to change settings

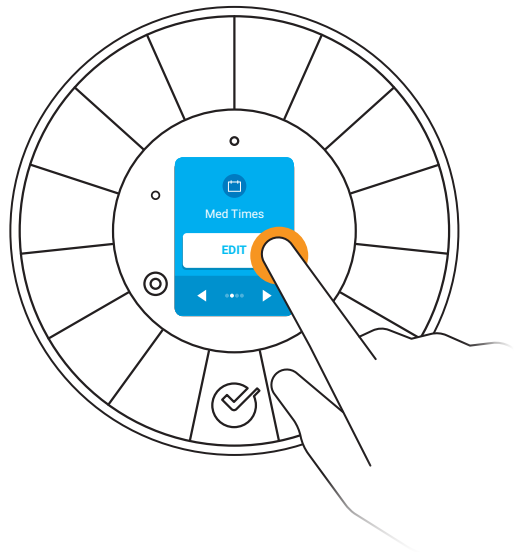
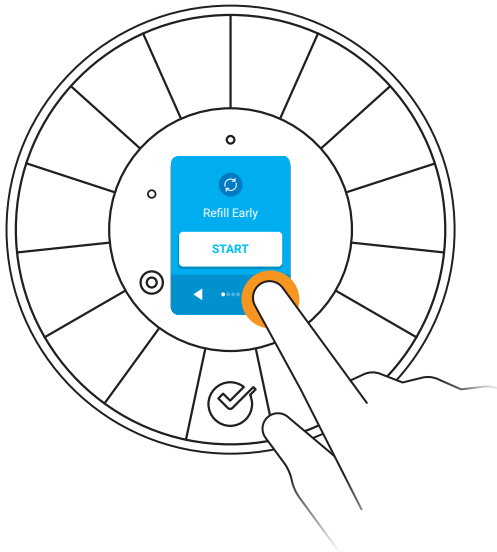

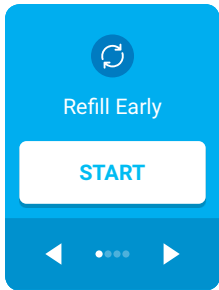

REFILLING EARLY

The pillbox will automatically request a refill when empty, but you can start a refill at any time from the Refill Early menu.

- **UNSCREW THE LID**
- Press **START** on the Refill Early screen
- Follow the on screen **GUIDE**
- **SCREW THE LID ON** to complete the refill

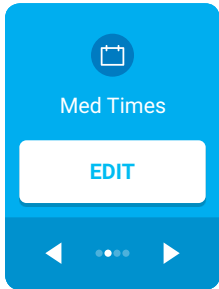

CHANGING MEDICATION TIMES

You can change your medication dispense times from the Med Times menu.

- **UNSCREW THE LID**
- Press the **RIGHT ARROW ONCE**
- Press **EDIT** on the Med Times screen
- Follow the on screen **GUIDE**

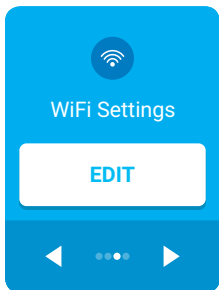

CONNECTING TO WiFi

Connecting to WiFi allows you to use **DOSE ANYWHERE**, our service that will send reminders when medications are dispensed, missed or waiting to be taken.

- **UNSCREW THE LID**
- Press the **RIGHT ARROW TWICE**
- Press **EDIT** on the WiFi Settings screen
- If you already connected or have a saved connection, you will see a status screen. Press the **RIGHT ARROW**
- Press **START** on the New Connection screen
- Follow the on screen instructions to connect

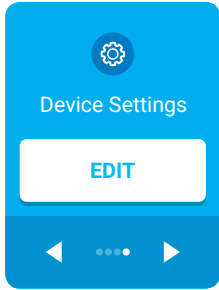

DEVICE SETTINGS

Pressing **EDIT** in the Device Settings screen brings up a new menu carousel with various settings you can change for your device as seen on the following pages.

Press the left and right **ARROWS** to navigate between the menus.

Some menus have ON/OFF **TOGGLE BUTTONS** that allow you to switch a feature ON or OFF like the alarm sound.

To close the device settings menu, press the **X** in the upper right corner.

TOGGLE BUTTONS can be pressed on either side to turn a setting on or off

To close the device settings carousel press the **X** in the upper right corner

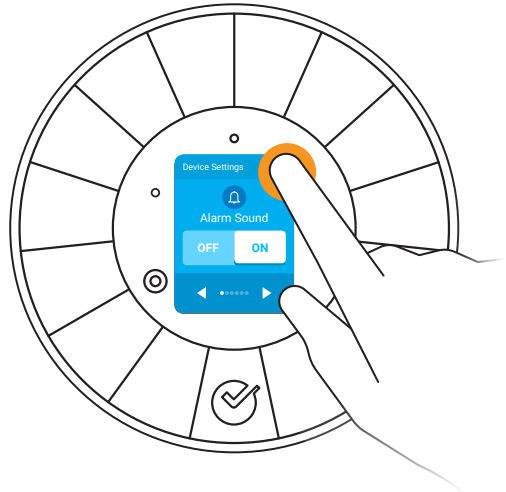
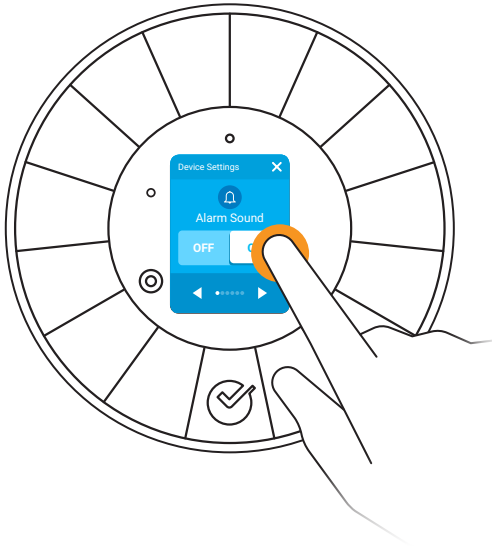

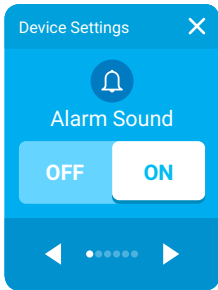

TURNING THE ALARM ON AND OFF

The alarm is a very helpful method to remind the user to take their pills, but sometimes it is useful to turn the alarm off.

- **UNSCREW THE LID**
- Press the **RIGHT ARROW THREE TIMES** to the Device Settings menu
- Press **EDIT** on the Device Settings menu
- Press the **ON/OFF TOGGLE** on the Alarm Sound menu to toggle the alarm on and off

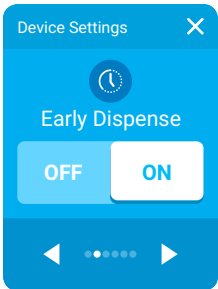

TURNING EARLY DISPENSE ON AND OFF

Occasionally you may need to leave the house and will end up missing a time to take your pills, in this case it is useful to dispense the next dose early.

- **UNSCREW THE LID**
- Press the **RIGHT ARROW THREE TIMES** to the Device Settings menu
- Press **EDIT** on the Device Settings menu
- Press the **RIGHT ARROW ONCE** to the Early Dispense menu
- Press the **ON/OFF TOGGLE** to toggle the Early dispense on and off

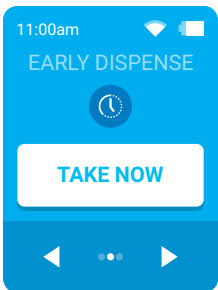

DISPENSING EARLY

If Early Dispense is turned on, there will be a third screen in the home menu carousel.

- With the **LID ON**, press the **RIGHT ARROW ONCE**
- Press **TAKE NOW** on the Early Dispense menu
- The tray will rotate and reveal your pills
- **FLIP** the pillbox to dispense
- In order to prevent users from accidentally dispensing too many pills early, after the Early Dispense feature is used it will not be available again until after the scheduled dispense time has passed.

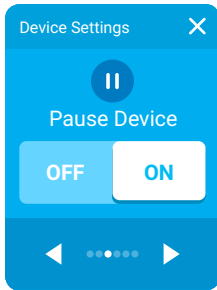

PAUSING THE PILLBOX

Sometimes you will want to suspend taking medications. You can do this by pausing the pillbox.

- **UNSCREW THE LID**
- Press the **RIGHT ARROW THREE TIMES** to the Device Settings menu
- Press **EDIT** on the Device Settings menu
- Press the **RIGHT ARROW TWICE** to the Pause Device menu
- Press the **ON/OFF TOGGLE** to pause or unpause the device

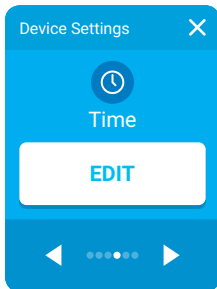

CHANGING THE TIME

Sometimes the current time on the pillbox will need to be adjusted, such as during Daylight Savings Time or when changing time zones.

- **UNSCREW THE LID**
- Press the **RIGHT ARROW THREE TIMES** to the Device Settings menu
- Press **EDIT** on the Device Settings menu
- Press the **RIGHT ARROW THREE TIMES** to the Time menu
- Press the **EDIT** button
- Follow the on screen instructions to set the time

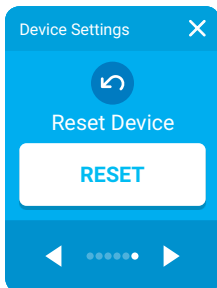

FACTORY RESETTING THE PILLBOX

Resetting the pillbox to factory setting will erase all the current medication schedules and delete the WiFi credentials. This can be useful if changing the device to another user.

- **UNSCREW THE LID**
- Press the **RIGHT ARROW THREE TIMES** to the Device Settings menu
- Press **EDIT** on the Device Settings menu
- Press the **RIGHT ARROW FOUR TIMES** to the Reset Device menu
- Press **RESET**
- **CONFIRM** that you are sure you want to reset. Please note: this cannot be undone

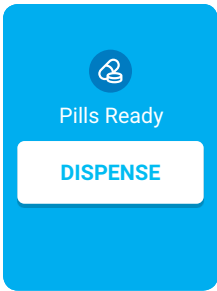
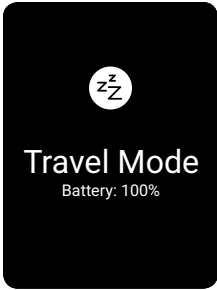

TRAVEL MODE

If the pillbox is unplugged, the screen will dim and it will enter into Travel Mode after 30 seconds. This is done to save power until you can plug it in again. The pillbox will still be able to dispense pills while in this mode.

- When it is **TIME TO DISPENSE** in Travel Mode, the screen will turn on and reveal a Pills Ready menu
- Press the **DISPENSE** button
- The tray will rotate to reveal the pills
- **FLIP** to dispense
- The pillbox will close and the screen will turn off again to save power

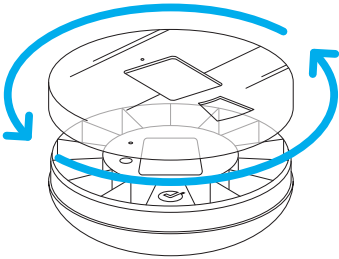

WAKING FROM TRAVEL MODE

While in travel mode, the touch screen is turned off to conserve power.

- To wake the pillbox, simply **PRESS THE SCREEN** for up to 5 seconds or **REMOVE THE LID** and wait for 10 seconds
- The pillbox will sleep again once the lid is replaced and after 30 seconds of inactivity

RESTARTING THE PILLBOX

If the device ever becomes unresponsive or seems to have frozen it can usually be solved by restarting the pillbox.

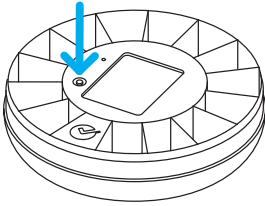

- **UNSCREW THE LID**
- **UNPLUG** the USB cord
- **PRESS AND HOLD THE RECESSED BUTTON** to the lower left of the screen for **3 TO 4 SECONDS**, the screen will turn off
- **PLUG IN** the USB cord, the screen will turn on

SECURING THE PILLBOX

It can be useful to lock the device with the included screw. It will prevent unwanted tampering or accidental opening.

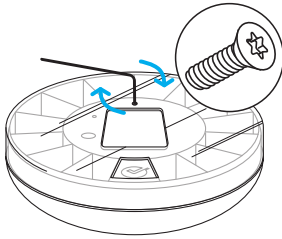

- With the **LID ON**
- Place the small **TORX SCREW** (in the small bag accompanying your device) in the hole above the screen
- Turn the screw clockwise with the supplied **TORX WRENCH**
- Place the wrench in a **SECURE PLACE** where it will not be lost or leave it in the box for storage

PILLS NOT TAKEN DAILY

Every time you refill the tray, the **A** space will represent the first medications of that **CURRENT DAY**. If you have a medication that is only taken on a specific day, you can tell which day each space represents by **COUNTING AHEAD** from the current day.

In the example on the left, the device is being refilled on a Wednesday, so space A and B are filled with Wednesday's medications. If a pill needs to be taken only on Friday morning, simply count ahead to find the correct space.

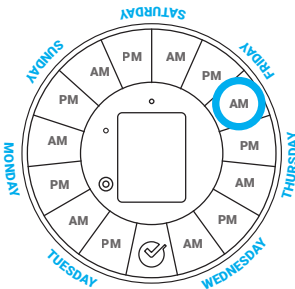

QUESTIONS OR COMMENTS?

If you have any issues using your device we want to hear from you and help! If you would like to call or email and leave a message with your name and a method to contact you, we will get back to you as soon as possible. Our number one goal is making a product that meets all of your expectations!

Thank you for choosing Dose Health!

PHONE: (844) 300-6212

EMAIL: support@dosehealth.com

WEB INSTRUCTIONS: dosehealth.com/instructions

